

VOLKTEK

Quick Installation Guide IMC-563P

1. Overview

IMC-563P is an Unmanaged PoE+ Industrial Mini-Media Converter designed for reliable network connectivity even in tough environment. The converter supports one 100/1000Base-T RJ45 port with IEEE802.3af/at PoE standard and one 100FX/1000Base-X SFP slot. With IP30 protection it exhibits extreme tolerance in harsh temperature environment ranging from -40°C to 75°C. IMC-563P quickly installation with no software or additional configuration needed, proves to be a perfect solution for round the clock surveillance in hard-to-reach locations.

2. Package Checklist

IMC-563P is shipped with the following items*. If any of these are missing or damaged, please contact your customer service representative for assistance.

- IMC-563P Device
- DIN rail kit
- Quick Installation Guide

* Contents of the package can be adjusted based on customer demand.

3. Hardware Installation Procedure

STEP 1:

Take out the device from its packing

STEP 2:

Attach the DIN rail kit as shown in picture

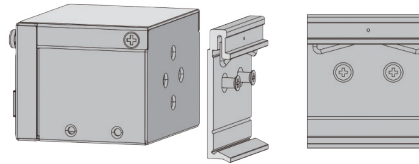

STEP 3:

Connect 48VDC adapter to power input or 48~57VDC input to terminal block of the IMC-563P

· Please note the "+" & "-" symbols before connecting terminal block.



Safety first

Turn the power off before connecting modules or wires. The correct power supply voltage is listed on the product label. Check the voltage of your power source to make sure that you are using the correct voltage. Do NOT use a voltage greater than what is specified on the product label.

Calculate the maximum possible current in each power wire and common wire. Observe all electrical codes dictating the maximum current allowable for each wire size. If current go above the maximum ratings, the wiring could overheat, causing serious damage to your equipment.

Note: Please MUST turn off the power before unplug/plug DC Jack or Terminal block connector

STEP 4:

Connect the Ethernet (RJ45) port to the media converter. See the L/A (Link/Activity) LED to confirm if the connection is established

STEP 5:

Insert the SFP module and connect the fiber cable to the fiber port

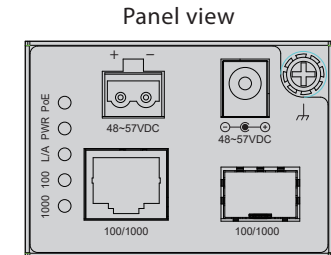

4. Location

The IMC-563P can be DIN-Rail-mounted in the cabinet or enclosure.

DIN-Rail-mounted with IMC-563P

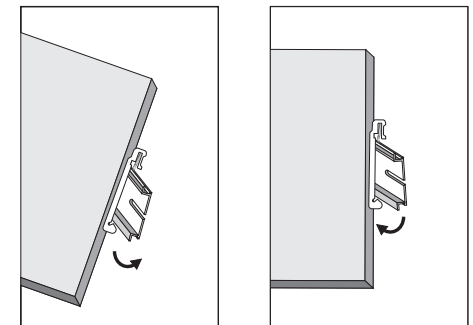

Mounting the Switch

Removing the Switch

5. Cabling RJ45

The RJ45 port on the IMC-563P supports auto negotiation and auto MDI/MDI-X. This feature eliminates the worry of using specific cable types.

Note: Category 5e cable or above should be used.

The related PoE pinout of RJ45 is shown in below.

Pin	Power	8-pin RJ45
1	V+	
2	V+	
3	V-	
6	V-	

6. LED Indicators

PoE (Green)	Illuminated	PoE power is delivered to PD device
	Off	No outgoing PoE power
PWR (Green)	Illuminated	Power on
	Off	Power off or failure
L/A Link/Activity (Green)	Illuminated	Ethernet (RJ45) link up
	Blinking	Activity(receiving or transmitting data)
	Off	Port disconnected or link failed
100 (Green)	Illuminated	Both RJ45 and SFP link speed at 100Mbps
	Off	Either SFP or RJ45 is not linking at 100Mbps speed
1000 (Green)	Illuminated	Both RJ45 and SFP link speed at 1000Mbps
	Off	Either SFP or RJ45 is not linking at 1000Mbps speed

7. Configuration diagrams

The Media converters can be used in pair to communicate between copper switch as in diagram 1 or single converter can be used to communicate between fiber and copper switch. Please follow below diagrams and associated table to set up your environment.

■ Diagram I: Converters used in pair

The below diagram illustrates how media converters can be used to increase the distance between two copper switches. To effectively communicate the speeds of copper and fiber ports of media converter must be same. The following table shows the speed user can use between media converter and switches and which LED will glow with respect to that speed.

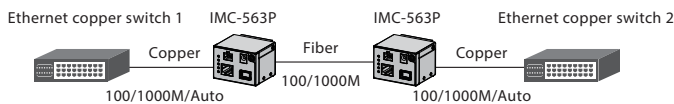

-4-

Media converter speed and respective LED

Item	Ethernet copper switch 1 Setting	SFP Type between IMC-563P	Ethernet copper switch 2 Setting	IMC-563P LED
1	Auto(100/1000)	GbE	Auto (100/1000)	1000
2	Auto (100/1000)	FX	Auto (100/1000)	100
3	Auto (100)	FX	Auto (100)	100
4	1G(Force)	GbE	1G(Force)	1000
5	100F (Force)	FX	100F (Force)	100
6	100H (Force)	FX	100H (Force)	100

■ Diagram II: Single Media Converter

The below diagram illustrates how one media converter can be used to increase the distance between copper switch and fiber switch. To effectively communicate the speeds of copper and fiber ports of media converter must be same.

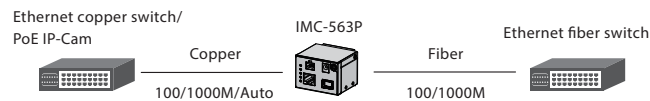

Media converter speed and respective LED

Item	Ethernet copper switch/PoE IP-Cam Setting	SFP used in IMC-563P	Ethernet fiber switch Setting	IMC-563P LED
1	Auto (100/1000)	GbE	GbE	1000
2	Auto (100/1000)	FX	FX	100
3	Auto (100)	FX	FX	100

-5-

LIMITED WARRANTY

VOLKTEK, a quality brand from VOLKTEK Corporation, warrants this product against defect in materials and workmanship for a period of FIVE (5) YEARS to the original purchaser.

If you discover a defect, VOLKTEK will, at its sole option, repair or replace the product at no charge to you, provided that you contact VOLKTEK technical support to obtain a Return Merchandise Authorization Number (RMA) and instruction on how and where repairs can be made.

This warranty does not apply if the product has been damaged by accident, abuse, misuse, misapplication, neglect, fire, water, lightning or other acts of nature, failure to follow supplied instructions, installation or removal, have been repaired or have undergone attempted repair by unauthorized personnel without written consent from VOLKTEK, modified, defaced, or has its serial numbers removed. VOLKTEK reserves the right to use remanufactured, refurbished, or used parts and components in making warranty repairs.

Certain features of third-party software or hardware designed for the host system may not be available when used with this product. Accordingly, VOLKTEK does not warrant that hardware or software will function error free when used in conjunction with this product.

This warranty is in lieu of all other warranties, whether oral or written, express or implied. All expressed or implied warranties for this product, including the implied warranties of merchantability and fitness for a particular purpose are limited in duration to the warranty period. No warranties expressed or implied will applied after this period. VOLKTEK shall not be liable for lost profits, damage to other property caused by any defects of this product, or damages based upon inconvenience, loss of product use, loss of time, commercial use, incidental and/or consequential damages for the breach of any expressed or implied warranty, including damages to property, and to the extent permitted by law, damages for personal injury, even if VOLKTEK has been advised of the responsibilities of such damages.

If you have any further questions, please contact Customer Support:

Website: www.volktek.com
 Email: support@volktek.com
 Tel: +886-2-8242-1000
 Fax: +886-2-8242-3333

-6-